



CONTACT FOR MORE INFORMATION: Patti Watson – 505-245-3134 (direct office); 505-269-9691 (cell phone); pattiw@cwastategic.com

CONSTRUCTION UPDATE: CREWS TO CLOSE INTERSECTION OF PASEO DEL NORTE AND UNSER BLVD. FOR BLASTING AS SOON AS WEDNESDAY, MAY 13, 2026

Closure Could Last for 30 Minutes to 1 Hour; Motorists Encouraged to Seek Alternate Route
[Update as of Friday, May 8, 2026](#)

As part of ongoing rock blasting for the Unser Blvd and Paseo del Norte Widening Projects, crews will **fully close the intersection of Unser Blvd. and Paseo Del Norte** as soon as **Wednesday, May 13, 2026**. This closure may last for **30 minutes to one (1) hour** and closures will occur **occasionally for the rest of the 2026 from Monday-Saturday as needed.** *Motorists are encourage to seek an alternate route.*

- From the **north**, and **west** take **Universe Blvd to Paradise Blvd to Golf Course Rd** to access Paseo Del Norte
- From the **east**, take **Golf Course to Paradise Road** to access Unser
- From the **south** take **Kimmick Drive** to access Paseo del Norte

Ongoing Traffic Impacts

Unser Blvd - Traffic is open in its existing alignment on southbound Unser.

Northbound Unser has a left lane, thru lane and thru/right lane open. At the intersection of Unser Blvd and Paradise Blvd, there is one left lane in addition to a thru/right lane

Paseo del Norte - Eastbound Paseo del Norte is reduced to one lane from west of Golf Course Road. The reduction of westbound Paseo del Norte to one lane has been moved further east, just past the pedestrian bridge. The bike lane is closed at the northwest corner of the intersection of Golf Course Road and Paseo del Norte

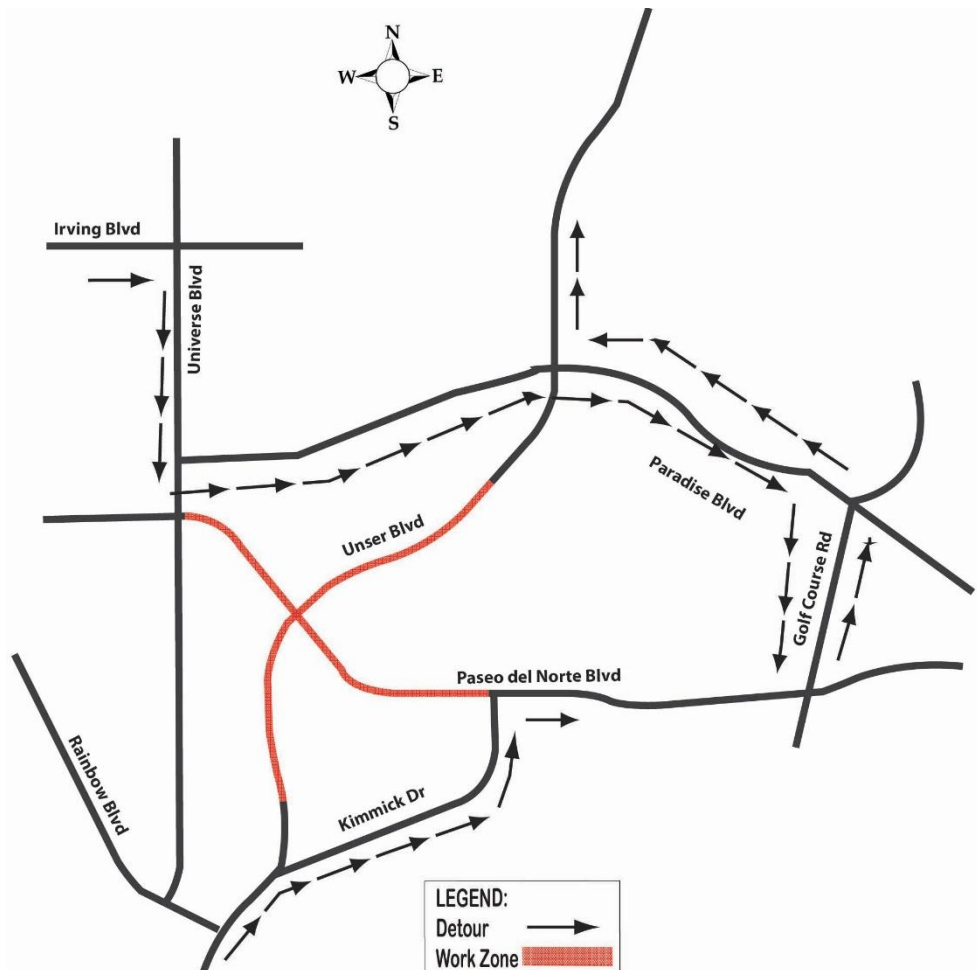

Regular work hours are **Monday-Friday 7 a.m.-4 p.m. and Saturday (as needed)** from 7 a.m.-2 p.m., though the contractor may work longer hours as needed. *NOTE: All construction is weather permitting and is subject to change without notice.* For more information, visit www.upgradeunserpaseo.com